

Canopy Instructions

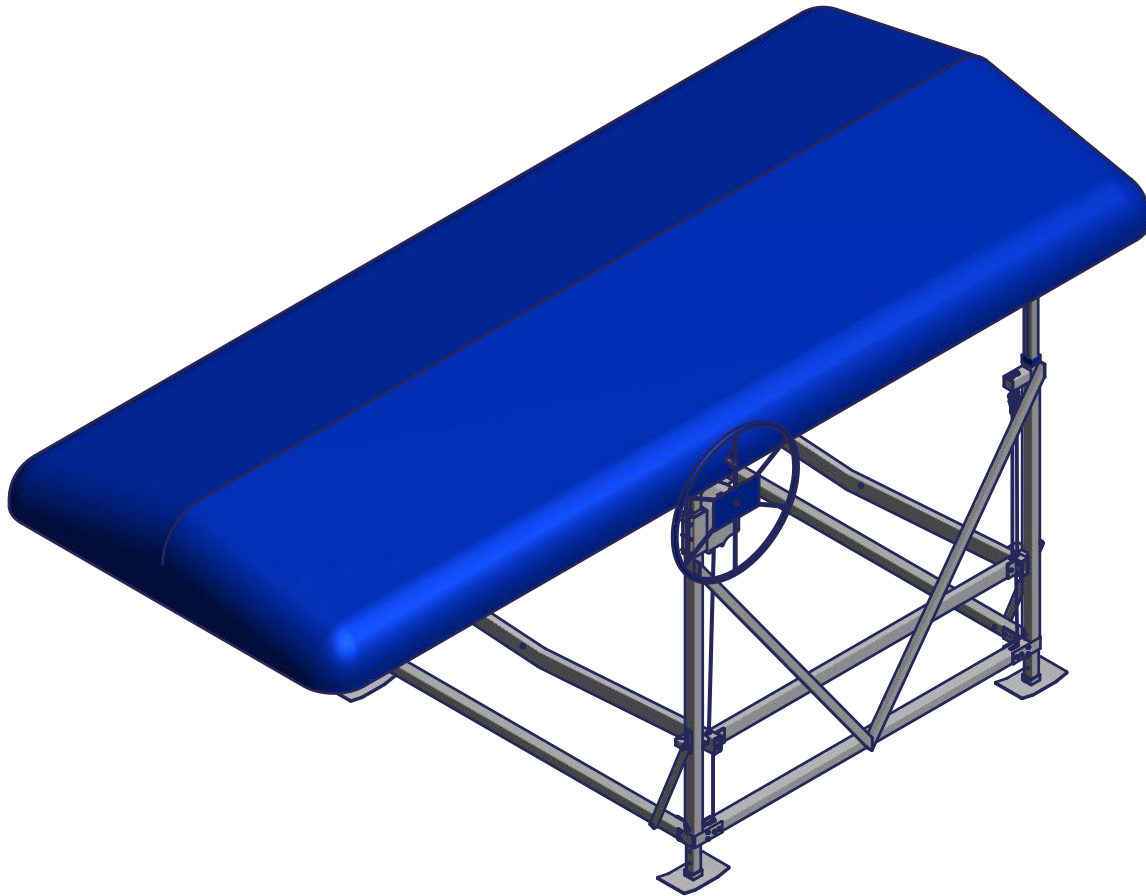

⚠ CAUTION - PUT SAFETY FIRST

1. NOT COMPLYING WITH THE PROCEDURES AND PRECAUTIONS OUTLINED IN THIS MANUAL MAY RESULT IN PERSONAL INJURY AND WILL INVALIDATE THE WARRANTY.
2. Before attempting to install this canopy, study and fully understand the proper operating procedures and safety precautions outlined in this owner's manual.
3. To avoid personal injury use proper protective clothing and safety eyewear when assembling, installing, removing, or servicing this product.
4. A canopy frame with the canopy cover attached is a wind hazard! Do not leave cover on frame unless canopy is secured to a properly installed boat lift.
5. Do not assemble or use this product if items are missing or damaged.
6. Canopy frame and cover cannot support excess weight. Do not stand on, hang from, or set heavy objects on canopy.
7. This product requires two or more persons to safely assemble and install.
8. Inspect all canopy bolts, nuts, cords, and hooks every three months for loose or damaged parts. Tighten or replace parts as needed.
9. If you have any questions about assembly, installation, or suitability of this product, contact an authorized dealer or ShoreMaster directly.

⚠ CAUTION - Your safety is the most important issue related to this product. It is critical that all assemblers, installers, and users read and fully understand the warnings and safety information contained throughout this manual before using this product. Failure to follow instructions may result in personal injury and may invalidate the applicable warranty.

Installation

The ShoreMaster canopy is used with ShoreMaster cantilever and vertical boat lifts. Many similarly designed canopy models are made by ShoreMaster. A canopy model may fit more than one boat lift model. A ShoreMaster canopy may fit many non-ShoreMaster brands. Contact ShoreMaster or an authorized dealer for more information.

Note: Canopy warranty applies only if installed with a genuine ShoreMaster manufactured frame and vinyl.

This product provides your boat with protection from the sun and rain. A canopy is a simple and time saving alternative to cumbersome mooring covers, provided your boat is properly raised and under your canopy.

The information in this manual is not all inclusive and does not cover all unique situations. Questions about assembly, installation, use, or suitability of this product can be answered by contacting an authorized ShoreMaster dealer.

Canopy Parts

- Two frame sides
- Two frame ends
- Four canopy legs
- One canopy cover
- Bolt Bag (See next page)

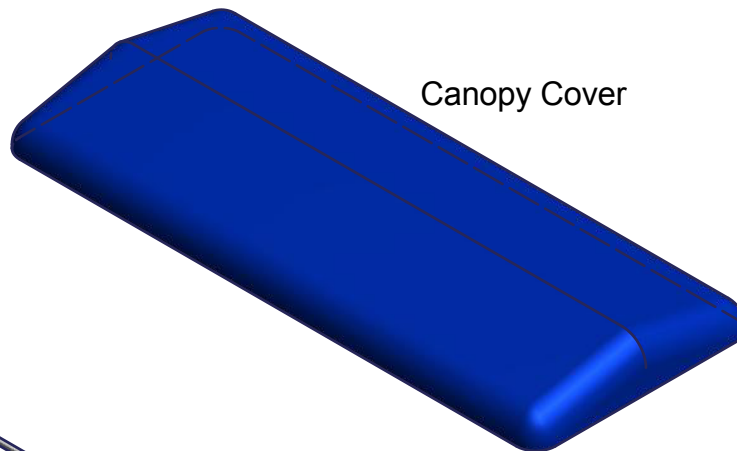

Canopy Cover



Canopy Leg

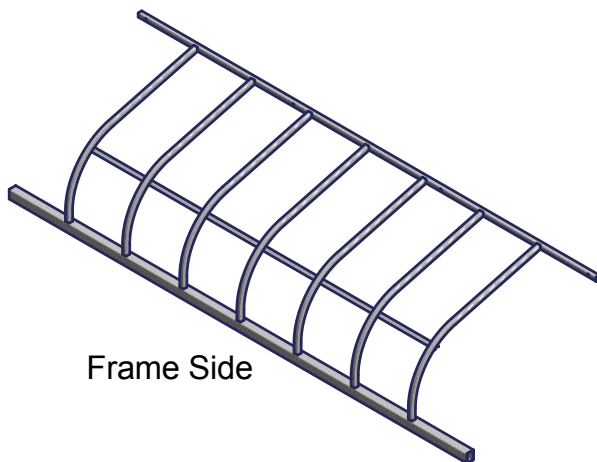

Frame Side

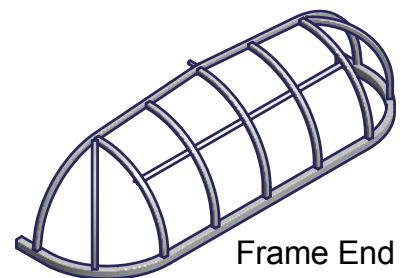

Frame End

TRADITIONAL CANOPY FRAMES

Canopy Bolt Bags

1006493 - Bolt Bag		
Qty	Part Number	Description
10	1001802	3/8 Flange Hex Nut
6	1001807	5/16 Hex Nut
10	1002431	3/8 x 2.75 Hex Bolt
6	1002455	5/16 x 2.5 Hex Bolt
10	1002599	3/8 Flat Washer
6	1002608	5/16 Flat Washer

10' x 55" Canopy

1006498 - Bolt Bag		
Qty	Part Number	Description
3	1001802	3/8 Flange Hex Nut
11	1001807	5/16 Hex Nut
4	1001970	5/16 x 2.5 Carriage Bolt
3	1002432	3/8 x 3.0 Hex Bolt
7	1002455	5/16 x 2.5 Hex Bolt
3	1002599	3/8 Flat Washer
18	1002608	5/16 Flat Washer

21' x 96" Canopy
21' x 108" Canopy

1006496 - Bolt Bag		
Qty	Part Number	Description
10	1001802	3/8 Flange Nut
7	1001807	5/16 Hex Nut
7	1001970	5/16 x 2.5 Carriage Bolt
10	1002431	3/8 x 2.75 Hex Bolt
10	1002599	3/8 Flat Washer
7	1002608	5/16 Flat Washer

10' x 110" Canopy

1000440 - Bolt Bag		
Qty	Part Number	Description
4	1001802	3/8 Flange Hex Nut
12	1001807	5/16 Hex Nut
4	1001956	3/8 x 1.0 Carriage Bolt
4	1001970	5/16 x 2.5 Carriage Bolt
8	1002455	5/16 x 2.5 Hex Bolt
20	1002608	5/16 Flat Washer

23' x 108" Canopy
23' x 120" Canopy

1004423 - Bolt Bag		
Qty	Part Number	Description
4	1001802	3/8 Flange Hex Nut
8	1001807	5/16 Hex Nut
4	1001970	5/16 x 2.5 Carriage Bolt
4	1002431	3/8 x 2.75 Hex Bolt
4	1002455	5/16 x 2.5 Hex Bolt
12	1002608	5/16 Flat Washer

13' x 64" Canopy

1004400 - Bolt Bag		
Qty	Part Number	Description
4	1001802	3/8 Flange Hex Nut
15	1001807	5/16 Hex Nut
4	1001956	3/8 x 1.0 Carriage Bolt
4	1001970	5/16 x 2.5 Carriage Bolt
4	1002438	3/8 x 4.0 Hex Bolt
11	1002455	5/16 x 2.5 Hex Bolt
30	1002608	5/16 Flat Washer

25' x 108" Canopy
25' x 120" Canopy
27' x 108" Canopy
27' x 120" Canopy
27' x 132" Canopy
29' x 120" Canopy
29' x 132" Canopy

1006497 - Bolt Bag		
Qty	Part Number	Description
3	1001802	3/8 Flange Hex Nut
10	1001807	5/16 Hex Nut
4	1001970	5/16 x 2.5 Carriage Bolt
3	1002431	3/8 x 2.75 Hex Bolt
6	1002455	5/16 x 2.5 Hex Bolt
3	1002599	3/8 Flat Washer
16	1002608	5/16 Flat Washer

19' x 84" Canopy

1026580 - Bolt Bag		
Qty	Part Number	Description
4	1001802	3/8 Flange Hex Nut
17	1001807	5/16 Hex Nut
4	1001956	3/8 x 1.0 Carriage Bolt
4	1001970	5/16 x 2.5 Carriage Bolt
4	1002438	3/8 x 4.0 Hex Bolt
13	1002455	5/16 x 2.5 Hex Bolt
34	1002608	5/16 Flat Washer

31' x 120" Canopy
31' x 132" Canopy
33' x 120" Canopy
33' x 132" Canopy
35' x 132" Canopy

Assembly and Installation

Note: Two or more people are needed to safely assemble and install canopy.

STEP 1

Place both frame sides with center tubes together as shown.

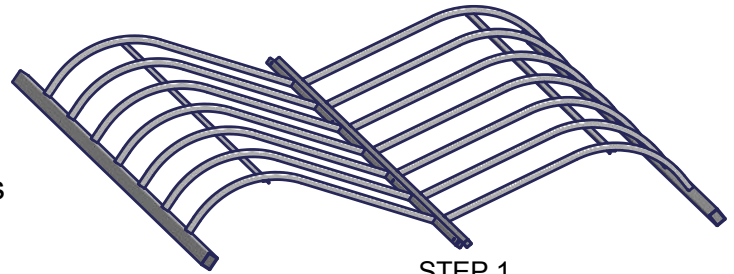

STEP 1

STEP 2

Hold both frame sides together as shown. Slide one canopy end frame into exposed ends of the frame sides as shown. Repeat this on the opposite end with other canopy end frame.

CAUTION To avoid personal injury secure ends in place for added security. The canopy ends are not held on with bolts. They are held in place by friction and secured when attaching the cover. They could fall out when moving the frame (without the cover in place) and injure you.

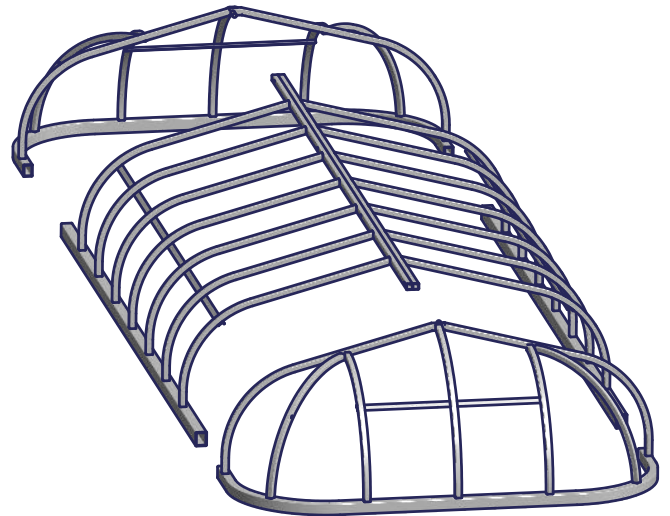

STEP 2

STEP 3

Bolt frame sides together as shown using 5/16 x 2-1/2 hex bolts, 5/16 hex nuts and 5/16 washers.

Note: If the bolt holes along the two frame sides do not line up perfectly, first try to improve the alignment by pushing down on the spine where the frame sides meet. If they still do not line up enough to insert a 5/16 bolt, it will not damage the canopy to drill out the bolt holes from one side using 3/8 drill bit.

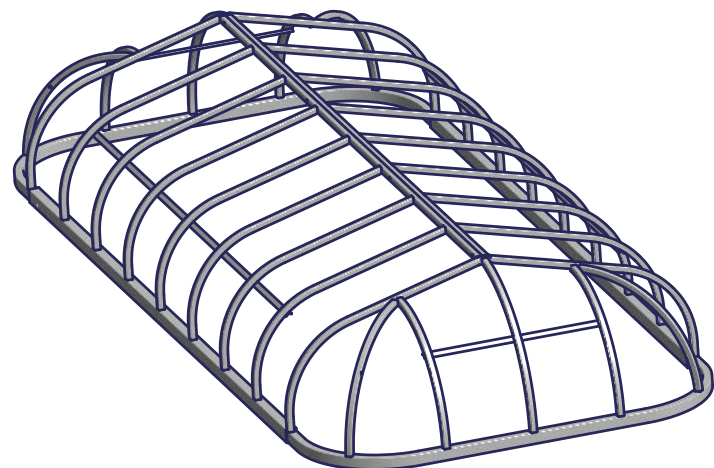

STEP 3

TRADITIONAL CANOPY FRAMES

Note: If you have a hydraulic lift skip STEP 4. If you have four slider legs skip to STEP 6.

STEP 4

Remove blue lift caps from boat lift uprights. Lower boat lift rack to full down position and make sure there is no weight on the lift. Loosen bolts and nuts holding boat lift winch in place and temporarily remove the winch from the lift upright. These bolts and nuts are reattached after the canopy leg is in place.

Note: If you have the clamp-on winch mount refer to STEP 6 for instructions on how to install the adjustable sliding leg.

STEP 5

Attach four canopy legs by sliding them into exposed opening in lift uprights. Each canopy leg must be bolted in place at same level. Bolt in place using your 3/8" hex bolts, and 3/8" flange nuts. The bolt lengths will vary depending on your model. For non-hydraulic lifts with bolt through canopy legs, use one bolt, nut, and washer for three of four canopy legs (reuse existing bolts and nuts attached to winch upright if available). Reattach the boat lift winch with the canopy leg in desired position.

Note: Hydraulic lift uses four 3/8 bolts, nuts, and washers to attach the canopy leg. Refer to canopy leg instructions available at your dealership or the ShoreMaster website for more instruction.

Note: The level your canopy legs are set at determines how high your canopy is compared with your boat lift. Canopy should be positioned as low as possible, while still allowing you access to boat from dock, when your boat is lowered into water. Estimate the distance to fully raise boat out of water (up and under your canopy) without interference. Proper canopy positioning also requires boat lift to be adjusted so lift is placed at proper dockside height.

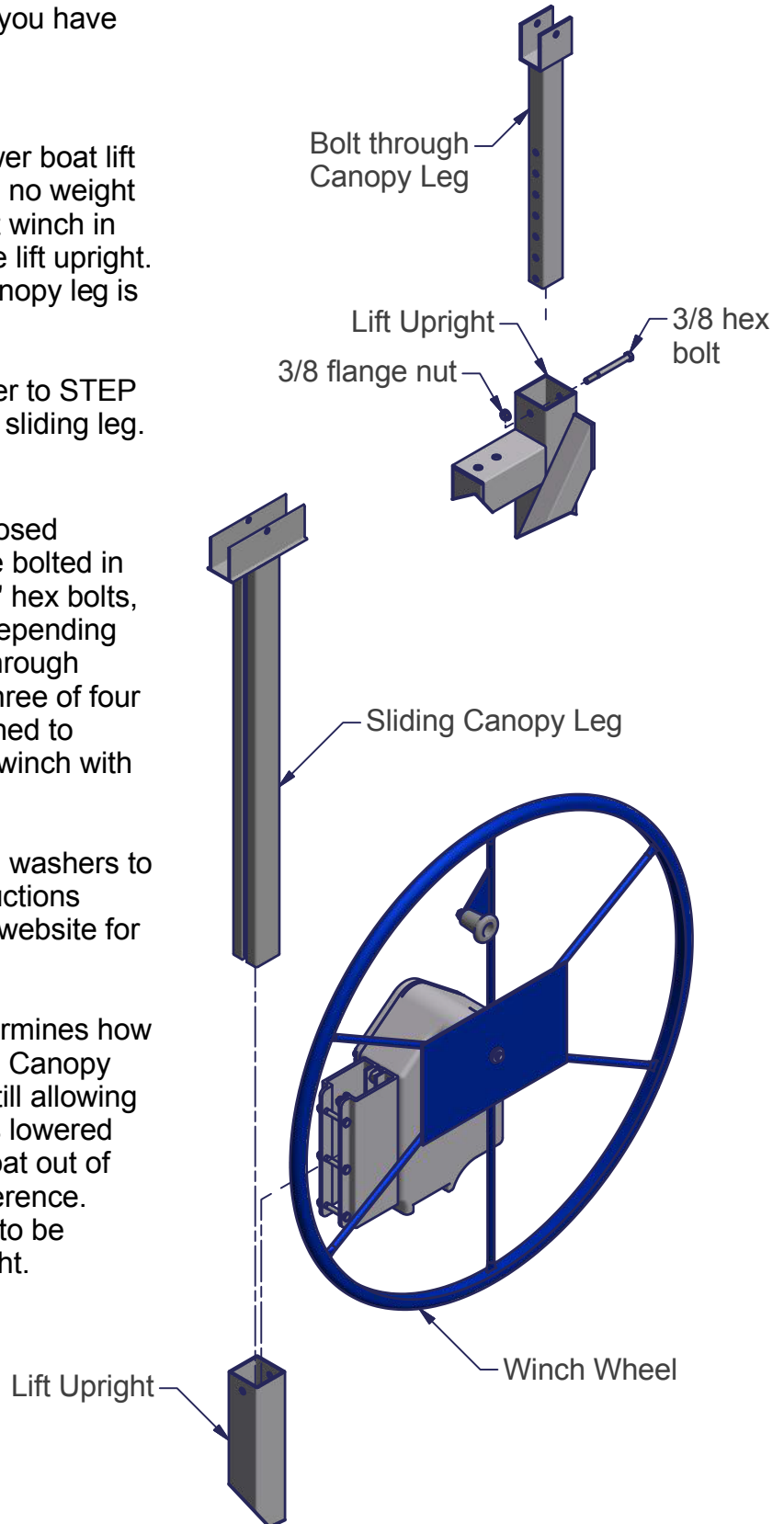

STEP 6

If you have sliding canopy legs, insert one 3/8 x 1 carriage bolt in the lift leg from the inside and attach loosely with one 3/8 brass nut as shown.

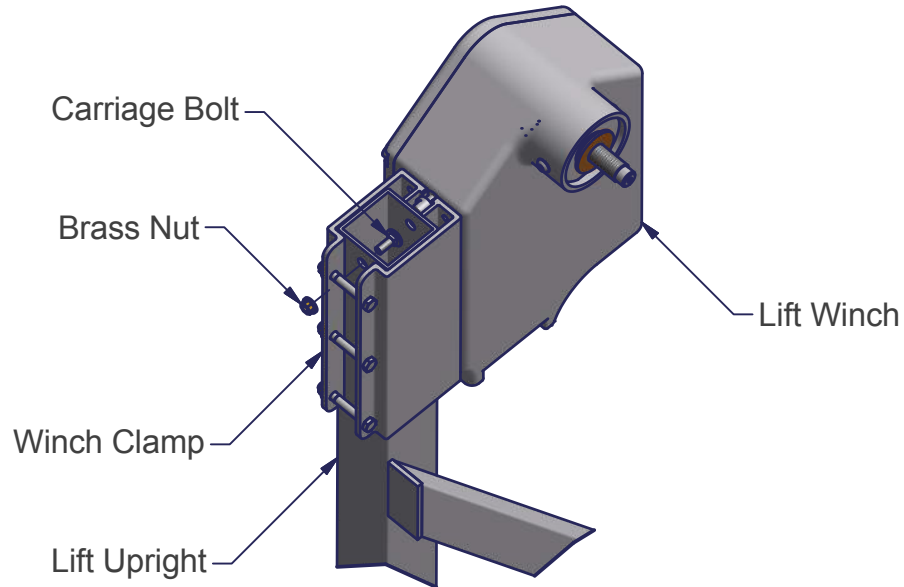
**STEP 7**

Slide the slotted canopy leg over the carriage bolt and tighten nut at desired height as shown.

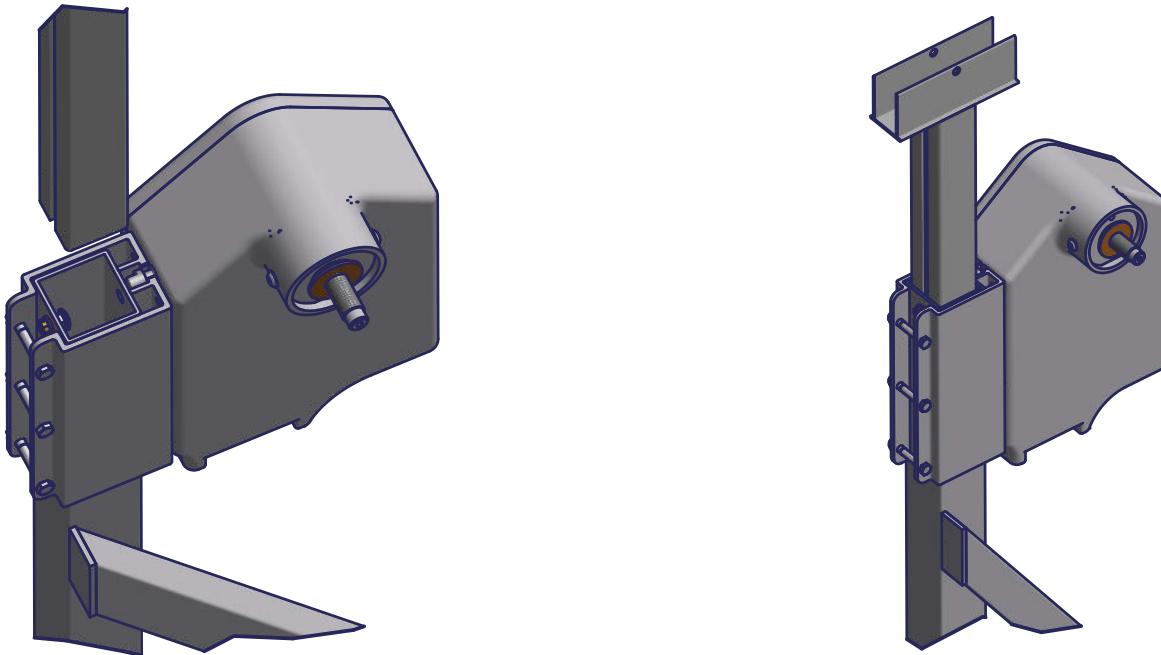

TRADITIONAL CANOPY FRAMES

STEP 8

Place the assembled canopy frame into the exposed U-shaped channels (saddles) of the canopy legs. Slide the canopy frame into desired position.

STEP 9

Place canopy cover over canopy frame. Position cover so it fits equally over the entire frame.

Note: Frame position should match estimated boat and motor position. Most boats are positioned forward in lift to provide proper balance and support. Usually 1-4 feet of canopy frame extends past rear of lift and the remaining 7-15 feet of frame extends past front of lift.

STEP 10

Bolt the frame in position with four 5/16 carriage bolts, 5/16 nuts, and 5/16 washers. One attached to each canopy leg as shown. Make sure head of carriage bolt is facing to the outside of the lift as shown.

CAUTION To avoid personal injury attach nuts and bolts holding canopy frame to canopy legs very tight. Not securing this properly could result in frame sliding or falling out of position resulting in damage to canopy, boat, or lift. A falling or slipping canopy could cause injury to anyone in the area.

CAUTION Canopy cover is a hazard if exposed to high winds! To avoid personal injury do not attach cover to canopy frame if wind affects your ability to safely fasten. Do not leave cover unattended on frame when attaching.

CAUTION Stretching and attaching bungee cords requires strength and proper balance. To avoid personal injury always wear proper protective clothing and safety glasses. Do not let go of bungee cords when under tension. An eye injury or other bodily injury could occur.

STEP 11

Be sure the frame is in the desired position before proceeding.

STEP 12

Secure the cover to the frame with the bungee cords on the inside of the cover. Take the bungee cord and pull it toward the outside of the canopy frame, down around the bottom beam of the canopy frame, and hook the end to the welded angle strip on the inside of the canopy bows.

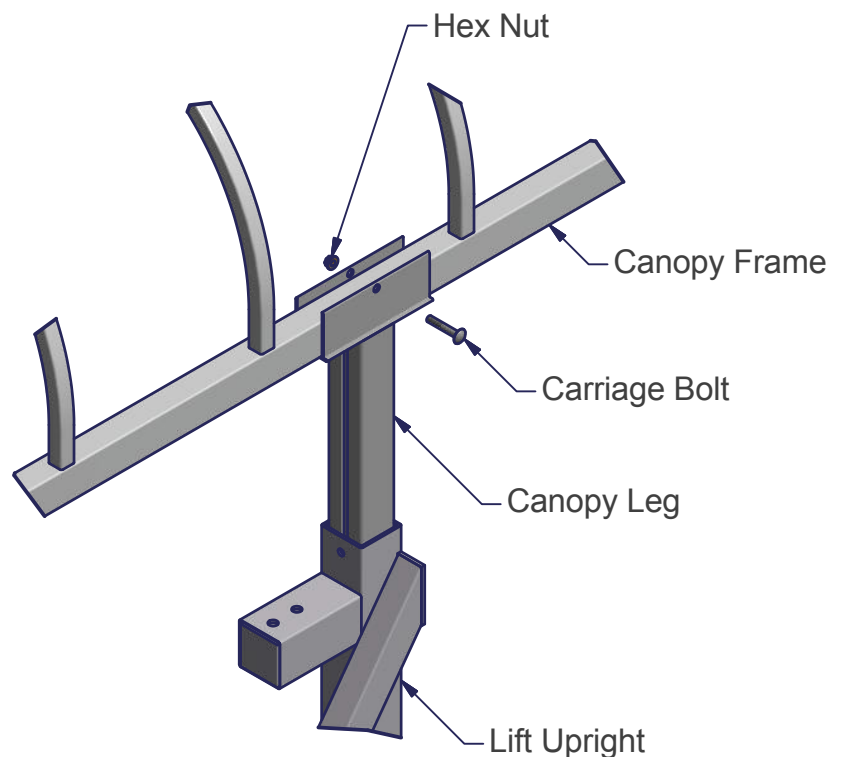

Operation and Use

Canopy provides best protection when your boat is positioned up and into the frame.

CAUTION

-Severe or strong winds can pick up a boat, lift, and canopy. This would cause damage to equipment and injury to anyone in its path. Position your boat up within canopy frame to provide protection and reduce chance of severe winds circulating inside canopy.

-Do not raise boat lift up past recommended lift height to position boat higher in canopy. Over raising may cause damage to lift, canopy, or boat. If over raising appears necessary to properly position boat, remove lift and canopy from water and adjust canopy legs to desired level.

-Do not leave cover on canopy frame unless boat lift is firmly in place. Sink lift leg pads into lake bottom. Settling is helped by leaving boat on lift for several days and covering lift leg pads with lake bottom soil. These steps provide a suction effect.

-Secure boat lift with canopy to lake bottom or a stand dock if you have a hard lake bottom (little or no soil), experience violent winds, will not have your boat in lift during strong winds, or if you are using a boat under 1400 lbs. You can use augers or trailer house anchors to provide needed additional security.

Removal and Storage

The canopy cover must be removed when boat lift is not properly secure in water or if not being used regularly. You can remove the cover by detaching the bungee cords from the canopy frame.

CAUTION

-Stretching and removing bungee cords requires strength and proper balance. Do not let go of bungee cords when under tension. An eye injury or other bodily injury could occur. Always wear proper protective clothing and safety glasses.

NOTICE

-Canopy frames and covers cannot support extra weight. Remove the cover if you experience snowfall. Not removing the cover and allowing accumulation of snow on canopy could damage the frame and the cover.

-Store the cover in a warm dry place. Be sure the cover is clean and dry before folding or rolling up for storage.

-Store canopy cover in a warm dry place to avoid cracks from freezing. Do not fold or handle the cover if temperature is below 45 degrees Fahrenheit, cracking could occur.

Service

A properly maintained canopy will require little service to the frame or structure. A canopy cover used under normal circumstances should provide 5 - 10 years of use before needing replacement.

Inspect all canopy bolts, nuts, cord, and hooks every three months for loose or damaged parts. Tighten or replace parts as needed.

Check other parts once a year for cracks, breaks or wear. Replace parts as needed.

If damage occurs to any part, replaced damaged item before resuming use.

NOTICE

Do not use chemicals or abrasives to clean your canopy cover. Using chemicals or abrasives will destroy your covers sun and mold protection. This will result in premature aging and decay of your cover. Use a soft dish soap and pressured water to clean your cover.