

Three Step Pivoting Ladder Instructions

Part #: 1006596

| Parts List | | | |
|------------|-----|-------------|--------------------------|
| ITEM | QTY | PART NUMBER | DESCRIPTION |
| 1 | 1 | 1005615 | Ladder Frame Left |
| 2 | 1 | 1005616 | Ladder Frame Right |
| 3 | 3 | 1005785 | Ladder Step |
| 4 | 12 | 1001950 | Bolt Carriage 1/4 x 3/4 |
| 5 | 12 | 1001797 | Nut 1/4 |
| 6 | 2 | 1000338 | Snap Pin |
| 7 | 2 | 1002469 | Poly Spacer |
| 8 | 4 | 1002599 | Washer Flat 3/8 SS |
| 9 | 2 | 1001805 | Nut 3/8 Nyloc |
| 10 | 1 | 1001778 | Ladder Pivot Left |
| 11 | 1 | 1001779 | Ladder Pivot Right |
| 12 | 2 | 1002426 | Phillips Screw 3/8 x 2.0 |

Failure to follow instructions may result in personal injury and may invalidate the applicable warranty.

Step 1. Attach each Ladder Step to the Left Ladder Frame and the Right Ladder Frame. Secure to Ladder Frame with two 1/4 x 3/4 Carriage Bolts and two 1/4 Nuts - as shown.

Step 2. Attach the Right Ladder Frame and Left Ladder Frame each to one Ladder Pivot. Secure with one 3/8 x 2.0 Slotted Round Bolt two Poly Spacers two 3/8 Flat Washers and one 3/8 Nyloc Nut - as shown.

While the ladder is in use secure it down with two Snap Pins (as shown).

Note: Nylock nuts should not be reused. If a Nylock nut is removed it must be replaced with a new Nylock nut.

Note: If the ladder is to be pivoted to a vertical position, the 3/8" x 2" bolts should go through the middle hole on the ladder pivot bracket and the lower hole on the ladder assembly (as shown).

If the Ladder is to be pivoted to a horizontal position across the dock, the 3/8" x 2" bolt should go through the upper hole on both the ladder pivots and the ladder assembly.

To pivot ladder, snap pins need to be removed.

Other Ladder Options

| | |
|---------|------------------------|
| 1006596 | Pivoting Ladder 3 Step |
| 1006597 | Pivoting Ladder 4 Step |
| 1006598 | Pivoting Ladder 5 Step |

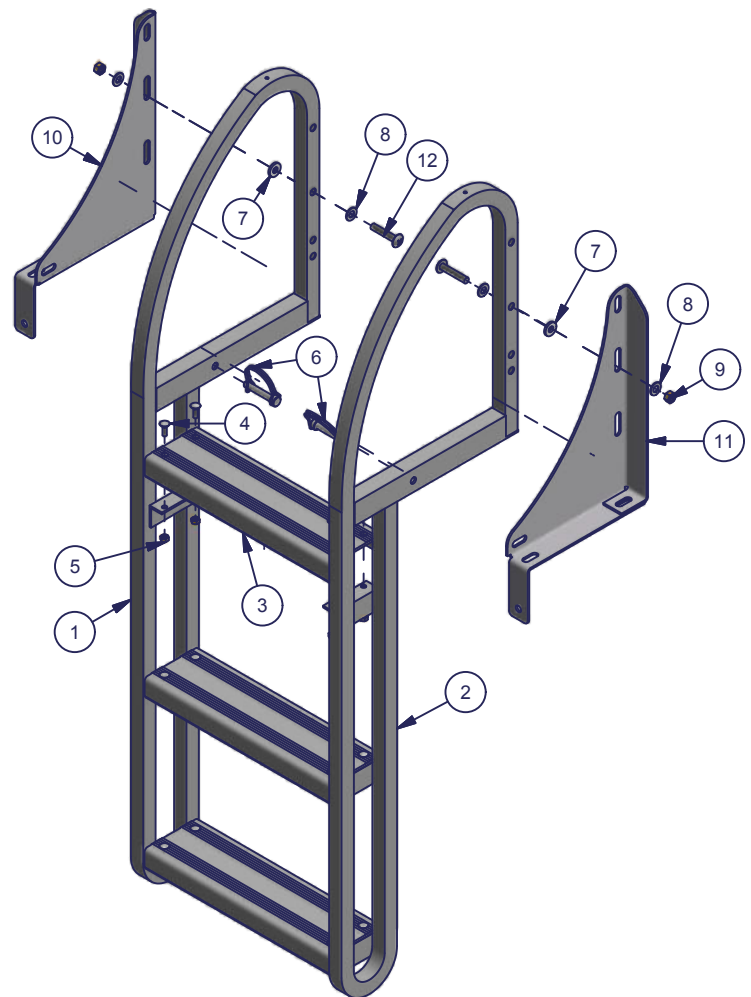

3 Step Pivoting Ladder

Mounting Instructions

Part #: 1006596

| Parts List | | | |
|------------|-----|-------------|--|
| ITEM | QTY | PART NUMBER | DESCRIPTION |
| 1 | 4 | 1002599 | Washer Flat 3/8" |
| 2 | 2 | 1002439 | Bolt Hex 3/8-16 x 4.0 Full Thread SS 304 |
| 3 | 2 | 1002435 | Bolt Hex 3/8-16 x 3.5 Full Thread SS 304 |
| 4 | 4 | 1001802 | Nut Flange 3/8" |
| 5 | 2 | 1004624 | Backer Plate |
| 6 | 8 | 1002576 | Wood Screw 1/4" x 1-3/4" |

Failure to follow instructions may result in personal injury and may invalidate the applicable warranty.

Step 1. Place ladder assembly on dock. Use the holes in the right and left Ladder Pivots, to mark holes to be drilled through deck.

Note: When locating ladder on the deck, make sure the cross braces under the deck will not interfere with the installation.

Step 2. Attach ladder assembly to deck with two 3/8 x 3 1/2 hex bolts through ladder pivot, deck and ladder pivot, mount with four 3/8 flat washers, two 3/8 flange nuts, and backer plate.

Step 3. With ladder assembly secured to the dock, use the lower holes in the ladder pivot as a guide to drill holes in dockside rails.

Step 4. Attach lower ladder pivot to side rail with two 3/8 x 4 hex bolts, two 3/8 flat washers and two 3/8 flange nuts (as shown).

Note: If the dock has removable deck sections, secure the section of the deck to which the ladder will be attached with eight #14 x 13/4" wood screws.

Note: These instructions are for a Shoremaster, pivoting ladder, installed on a Shoremaster Brand dock only. Different hardware may be needed in attaching ladder to another brand of dock.

